

## B 10 Repairing, adjusting injection nozzle, after testing

### Note! Omitted on engine 602.982

Preceding work: ..... Removing, installing injection nozzle (07.1-6810)  
Testing injection nozzle (07.1-6712).

Operation no. of operation texts or standard texts and flat rates ..... 07-6750 or 07-6752

- 1 Injection nozzles, .....
- 2 Nozzle needle (31) .....
- 3 Nozzle body (32) .....
- 4 Intermediate plate (33) .....
- 5 Pressure pin (34) .....
- 6 Nozzle tensioning nut (35) .....
- 7 Compression spring (36) .....
- 8 Holding body (37) .....
- 9 Steel washer (40) .....

repair.  
remove, install. Perform visual inspection and sliding test.

remove combustion residues.  
dress on dressing plate.  
remove, insert. Tip must face toward upper part.  
unscrew, screw on. Tightening torque 70 - 80 Nm.  
remove, insert.  
clamp in protective jaws for disassembling and assembling injection nozzles.  
for adjusting ejection pressure.

**Specification:**  
115 - 125 bar for new or newly adjusted nozzle, at least 110 bar for used nozzle. Depending on thickness of washer, ejection pressure higher or lower. 0.02 mm results in pressure difference of approx. 2 - 3 bar.

## B 10 Adjusting injection nozzle, after testing

Engine 604 DFI, 605/606 IFI

Fig. 1

- 31 Nozzle needle
- 32 Nozzle body
- 33 Intermediate plate
- 34 Pressure pin
- 35 Nozzle tensioning nut
- 36 Compression spring
- 37 Holding body
- 40 Steel washer

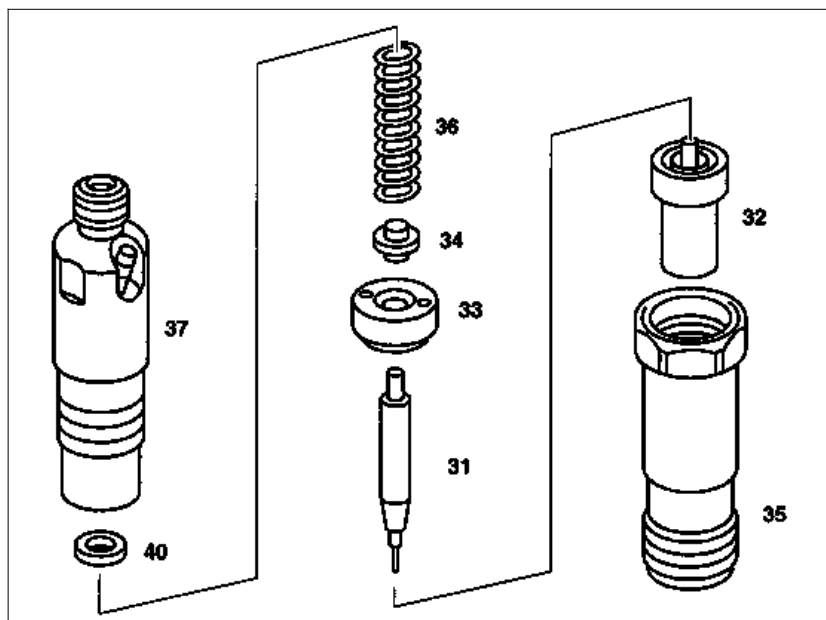

P07-6352-57

## B 10 Adjusting injection nozzle, after testing

### Special tools

