

91-638 Removal and Installation of Seat Belt Lock (Driver's Seats)

Operation carried out beforehand:
Seat removed (91-100/91-110)

Operation No. of Operation Texts and Work Units, Standard Texts and Flat Rates..... 91-1516

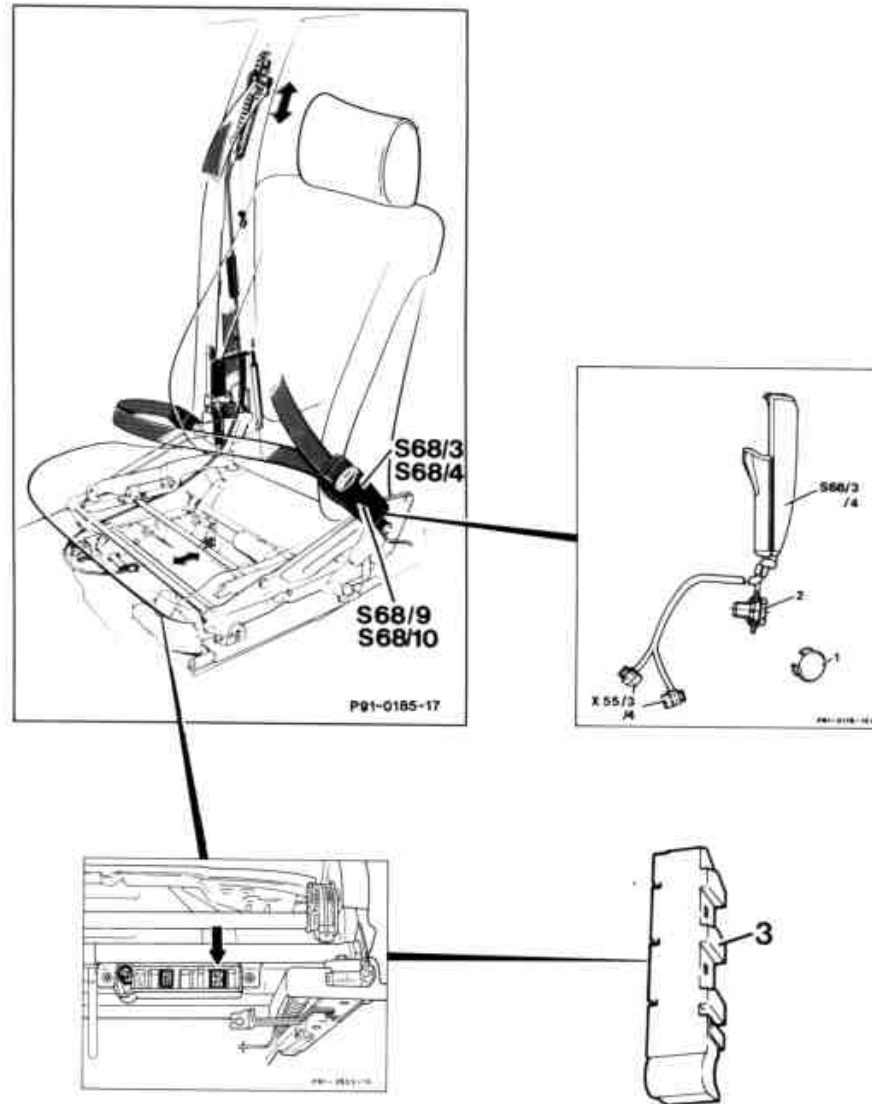

P91-5015-59

Removal

- Cable duct, cable bands and insulation tape on the underside of the seats..... open.
- Cover (3)..... push off.
- Plug connectors (arrows)..... remove.
- Cover (1)..... push out with wedge.
- Screw (2) on seat belt lock..... unscrew and remove seat belt lock with cable.

Install in reverse sequence.